

Weld Screw, Ring Projection, Plain

The information below lists the required dimensional, chemical and physical characteristics of the products in this purchase order. If the order received does not meet these requirements, it may result in a supplier corrective action request, which could jeopardize your status as an approved vendor. Unless otherwise specified, all referenced consensus standards must be adhered to in their entirety.

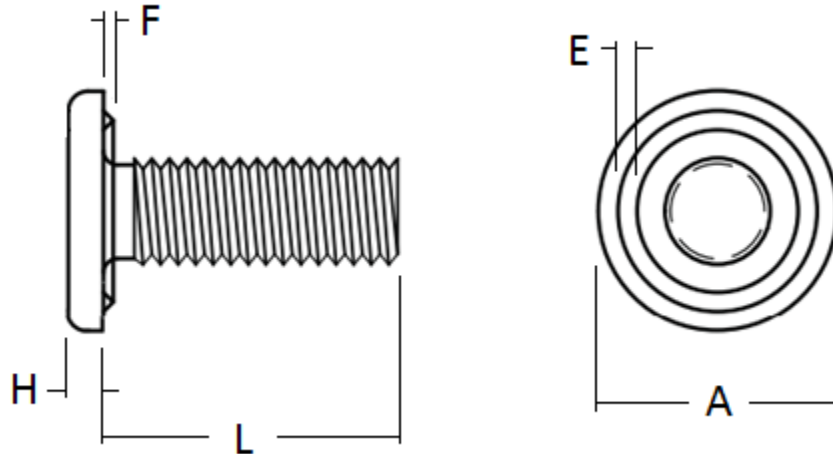

Size	A		H		E	F	
	Head Diameter		Head Height		Projection Width	Projection Height	
	Min.	Max.	Min.	Max.	Ref.	Min.	Max.
#10	.428	.448	.058	.068	.035	.015	.020
1/4	.550	.575	.073	.083	.048	.021	.027
5/16	.725	.755	.089	.099	.060	.027	.033
3/8	.850	.880	.104	.114	.068	.031	.037

*Length Tolerance: Under 1" (+.000/-.03") 1 to 2" (+.000/-.062") Over 2" (+.000/-.093")

Specification Requirements:

- Dimensions: See Table Above
- Material: C1008 or C1010 welding quality carbon steel
- Thread Requirements: ASME B1.1, Class 2A. Studs with nominal lengths of 2" or less should have threads extend to within one thread of the top of the weld projections. Studs over 2 inches should have minimum thread length of 1.75".
- Tensile Strength: 60,000 psi minimum
- Finish: Light Protective Oil