



ROCK RIVER



Hand Tools & Accessories Catalog



To Our Valued Customers,

Thank you for the opportunity to present our fast-growing lineup of Rock River hand tools!

As you look through the catalog, keep in mind that these products are manufactured by Fastenal's most trusted domestic and global suppliers – in many cases, alongside the iconic brand-name tools you've relied on for years.

The factories, testing and quality are the same. The difference is that Fastenal owns the supply chain from the factory floor to your local store, enabling us to streamline steps, eliminate mark-ups, and pass the savings along to you. So, if you're looking for industrial-grade tools made by the best manufacturers on earth, you'll find them here ... and more importantly, at your local Fastenal store.

Thanks again for giving Rock River tools a closer look. We're confident that once you experience the quality, you'll want to make them a part of your toolbox for years to come.

PAVE
the way

Contents

Page

4-8	Socket Products & Sets
9	Ladders
10	Wrenches, Wrench Sets & Accessories
11	Hex & Torx Key Products
11-13	Bit Tips & Drivers
13-14	Screwdrivers, Sets & Accessories
14	Nut Drivers & Sets
14-16	Pliers, Pliers Sets & Accessories
16-17	Clamps
17	Vises
18-19	Paint, Marking & Accessories
19-20	Hammers
20	Pry Bars
20	Bolt Cutters
20-21	Hacksaw Frames & Blades
21	Scissors, Snips & Shears
21	Tape Measures & Squares
21	Batteries
21	Flashlights
22-23	Knives, Razors, Multi-Tools & Accessories
24	Putty Knives & Scrapers
24-26	Tool Storage
27	Shovels, Spades & Post Hole Diggers
28	Landscaping Tools
29	Generators & Compressors
30-31	Wet/Dry Vacs

Distributed Exclusively by

FASTENAL®



Painting Supplies

Whether the job is big or small, Rock River has a variety of the painting supplies needed get the work done.



Rock River professional grade brushes have been finely chiseled and trimmed to provide a clean cutting edge and even flow of paint.



0602090
Tray Liner



0602072
Roller Covers

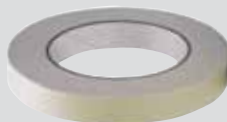

0604698
Masking Tape



0612411
Drop Cloth



0602082
Roller Frames



0222949
Putty Knives

* Find on page 24

Visit **Fastenal.com/RockRiver**
to view the complete selection of painting supplies by Rock River.

Distributed Exclusively by

FASTENAL

Individual Sockets

1/4" Drive

Series - Standard		
Number of Points	6	12
Size	Part No.	Part No.
3/16"	2112408	2112401
7/32"	2112409	2112402
1/4"	2112410	2112403
9/32"	2112411	2112404
5/16"	2112412	2112405
11/32"	2112413	2112406
3/8"	2112414	2112346
7/16"	2112415	2112348
1/2"	2112416	2112350
9/16"	2112417	2112560

Series - Deep		
Number of Points	6	12
Size	Part No.	Part No.
3/16"	2112390	2112379
7/32"	2112391	2112380
1/4"	2112392	2112381
9/32"	2112393	2112382
5/16"	2112394	2112383
11/32"	2112395	2112384
3/8"	2112396	2112385
7/16"	2112397	2112386
1/2"	2112398	2112387
9/16"	2112399	2112388

Series - Torx	
Size	Part No.
T-10	2112328
T-15	2112329
T-20	2112330
T-25	2112331



Universal Joints

1/4" Drive Accessories

Part No.	Type
2112441	Universal Joint
2112442	Ratchet
2112443	3" Extension
2112444	6" Extension
2112445	Spinner Handle



2112441



2112443



2112445



2112442

Socket Sets

1/4" Drive Sets

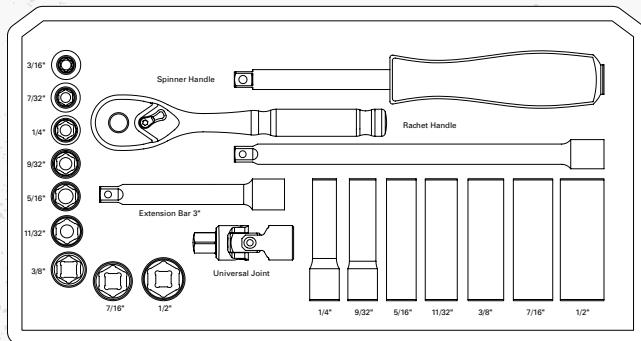

2112440



Part No.	Style	Number of Pieces	Series	Number of Points	Size	Contents
2112327	Torx	9	Torx		T10, T15, T20, T25, T30, T40, T45, T50	(9) Torx Bit Drive Socket, plastic hanger
2112378	SAE	10	Deep	12	3/16", 7/32", 1/4", 9/32", 5/16", 11/32", 3/8", 7/16", 1/2", 9/16"	(10) Deep Sockets, plastic hanger
2112389	SAE	10	Deep	6	3/16", 7/32", 1/4", 9/32", 5/16", 11/32", 3/8", 7/16", 1/2", 9/16"	(10) Deep Sockets, plastic hanger
2112400	SAE	10	Standard	12	3/16", 7/32", 1/4", 9/32", 5/16", 11/32", 3/8", 7/16", 1/2", 9/16"	(10) Standard Sockets, plastic hanger
2112407	SAE	10	Standard	6	3/16", 7/32", 1/4", 9/32", 5/16", 11/32", 3/8", 7/16", 1/2", 9/16"	(10) Standard Sockets, plastic hanger
2112440	SAE	21	Both	6	Standard: 3/16", 7/32", 1/4", 9/32", 5/16", 11/32", 3/8", 7/16", 1/2"; Deep: 1/4", 9/32", 5/16", 11/32", 3/8", 7/16", 1/2"	(9) Standard Sockets, (7) Deep Sockets, Ratchet, 3" & 6" Extensions, 6" Spinner Handle, Universal Joint, Blow Case

Individual Sockets

3/8" Drive

Series - Standard	
Number of Points	12
Size	Part No.
1/4"	2112357
3/8"	2112345
7/16"	2112347
1/2"	2112349
9/16"	2112351
5/8"	2112353
11/16"	2112354
3/4"	2112355
13/16"	2112356
7/8"	2112561
8MM	2112462
9MM	2112463
10MM	2112464
11MM	2112465
12MM	2112466
13MM	2112467
14MM	2112468
15MM	2112469
16MM	2112470
17MM	2112471
18MM	2112472
19MM	2112473

Series - Deep	
Number of Points	6
Size	Part No.
3/8"	2112562
7/16"	2112563
1/2"	2112314
9/16"	2112312
5/8"	2112316
11/16"	2112318
3/4"	2112320
13/16"	2112322
7/8"	2112324
8mm	2112484
9mm	2112485
10mm	2112486
11mm	2112475
12mm	2112476
13mm	2112477
14mm	2112478
15mm	2112479
16mm	2112480
17mm	2112481
18mm	2112482
19mm	2112483

Series - Torx	
Size	Part No.
2112556	T-25
2112332	T-30
2112333	T-40
2112334	T-45
2112335	T-50



Extensions

3/8" Drive Accessories

Part No.	Type
2112419	3" Extension
2112420	6" Extension
2112421	Teardrop Ratchet
2112557	Ratchet
2112558	Cushion Grip Ratchet



Socket Sets

3/8" Drive Sets

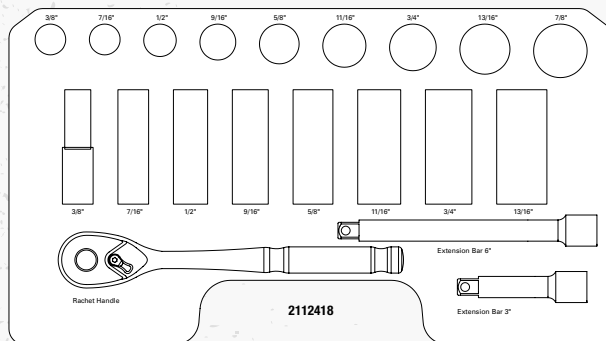

Part No.	Number of Pieces	Style	Number of Points	Series	Size	Contents
2112344	9	SAE	12	Standard	1/2", 9/16", 5/8", 11/16", 3/4", 13/16", 7/8", 15/16", 1"	(9) Standard Socket Set, plastic hanger
2112418	20	SAE	6 and 12	Both	3/8", 7/16", 1/2", 9/16", 5/8", 11/16", 3/4", 13/16", 7/8"	(8) Deep Sockets, (9) Standard Sockets, Quick-Release Ratchet, 3 and 6" Extension Bars, Blow Case
2112461	12	Metric	12	Standard	8mm, 9mm, 10mm, 11mm, 12mm, 13mm, 14mm, 15mm, 16mm, 17mm, 18mm, 19mm	(12) Standard Socket, plastic hanger
2112474	12	Metric	6	Deep	8mm, 9mm, 10mm, 11mm, 12mm, 13mm, 14mm, 15mm, 16mm, 17mm, 18mm, 19mm	(12) Deep Socket, plastic hanger
2112574	9	SAE	6	Deep	3/8", 7/16", 1/2", 9/16", 5/8", 11/16", 3/4", 13/16", 7/8"	(9) 6 Point Deep Sockets, Plastic Hanger
2112327	9	Torx		Torx	T10, T15, T20, T25, T30, T40, T45, T50	(9) Torx Bit Drive Socket, plastic hanger
2112336	7	Standard		Hex	1/8", 5/32", 3/16", 7/32", 1/4", 5/16", 3/8"	(7) Hex Bit Socket Set, plastic hanger
2112487	6	Metric		Hex	4mm, 5mm, 6mm, 7mm, 8mm, 10mm	(6) Hex Bit Sockets, plastic hanger

Individual Sockets

1/2" Drive

Series - Standard	
Number of Points	12
Size	Part No.
3/8"	2112376
7/16"	2112564
1/2"	2112565
9/16"	2112566
5/8"	2112568
11/16"	2112567
3/4"	2112569
13/16"	2112570
7/8"	2112571
15/16"	2112572
1"	2112372
1-1/16"	2112373
1-1/8"	2112374
1-3/16"	2112377
1-1/4"	2112375
Series - Deep	
Number of Points	6
Size	Part No.
1/2"	2112313
9/16"	2112311
5/8"	2112315
11/16"	2112317
3/4"	2112319
13/16"	2112321
7/8"	2112323
15/16"	2112325
1"	2112326



Ratchets & Sets

1/2" Drive Accessories

Part No.	Type
2112423	Ratchet
2112424	Flex Handle
2112425	5" Extension
2112559	Ratchet



Socket Sets

1/2" Drive Sets

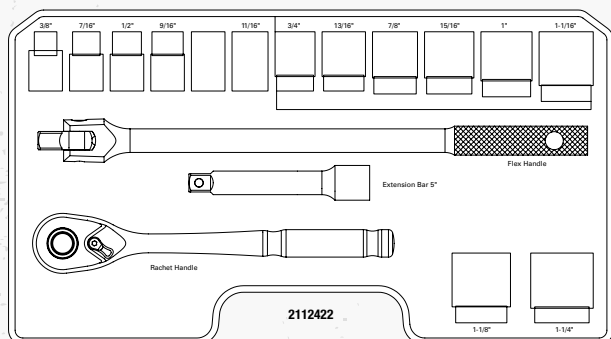

Part No.	Number of Points	Style	Series	Size	Contents
2112310	6	SAE	Deep	1/2", 9/16", 5/8", 11/16", 3/4", 13/16", 7/8", 15/16", 1"	(9) Deep Sockets, plastic hanger
2112422	12	SAE	Deep	7/16", 1/2", 9/16", 3/8, 5/8", 11/16", 3/4", 13/16", 7/8", 15/16", 1", 1-1/16", 1-1/8", 1-1/4"	(14) Standard Sockets, (3) Drive Tools, Ratchet, 15" Flexible Handle, 5" Extension Bar
2112573	12	SAE	Standard	3/8", 7/16", 1/2", 9/16", 5/8", 11/16", 3/4", 13/16", 7/8", 15/16", 1", 1-1/16", 1-1/8", 1-1/4"	(14) 12 Point Standard Sockets, Plastic Rail
2112494	6	Metric / Hex	Metric	H6, H7, H8, H10, H12, H14, H17, H19	(7) Hex Bit Socket, Plastic hanger
2112502	6	Hex	Metric	1/4", 5/16", 3/8", 7/16", 1/2", 9/16", 5/8"	(7) Hex Bit Socket, Plastic hanger

Individual Sockets

3/4" Drive

Part No.	Size	Number of Points	Series
2112427	7/8"	12	Standard
2112428	15/16"	12	Standard
2112429	1"	12	Standard
2112430	1-1/8"	12	Standard
2112431	1-1/4"	12	Standard
2112432	1-7/16"	12	Standard
2112433	1-1/2"	12	Standard
2112434	1-5/8"	12	Standard
2112435	1-3/4"	12	Standard
2112436	2"	12	Standard



Extensions

3/4" Drive Accessories

Part No.	Type
2112437	4" Extension
2112438	8" Extension
2112439	Ratchet



2112437



2112438



2112439

Socket Sets With Drive Tools

3/4" Drive Sets

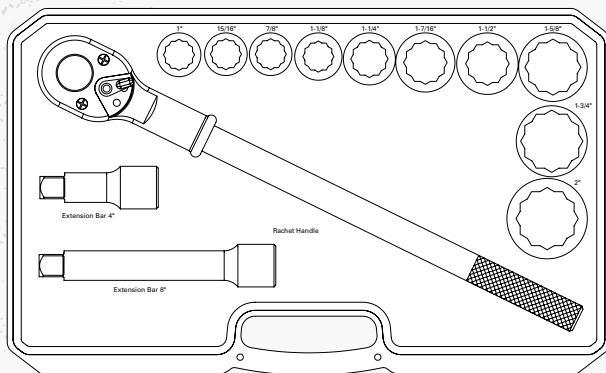

Part No.	Number of Points	Style	Series	Size	Contents
2112426	12	SAE	Standard	7/8", 15/16", 1", 1-1/8", 1-1/4", 1-7/16", 1-1/2", 1-5/8", 1-3/4", 2"	(10) Standard Sockets, 2 Extension Bars, 1 Reversible Ratchet, Blow Case

**Quality that's worthy of your work
- we guarantee it.**

We have confidence in our products, and we want you to as well. That's why every Rock River hand tool is warranted for life to be free from defects in design, workmanship and material.

We're proud to offer this lifetime warranty, and even prouder that you'll never have to use it.



Impact Sockets

3/8" Drive

Rock River distinguished and characteristic forging enable the socket to form the concentricity in the center. Besides, the fine structure of the socket is stabilized after heat treating so as to provide the best performance and lower the vibration when air wrench is moving with high speed RPMs.

Number of Points: 6		
Series	Standard	Deep
Size	Part No.	Part No.
5/16"	2112293	2112302
3/8"	2112294	2112303
7/16"	2112295	2112304
1/2"	2112296	2112305
9/16"	2112297	2112306
5/8"	2112298	2112307
11/16"	-	2112308
3/4"	2112299	2112309
13/16"	2112300	-

Hex Bit Impact Sockets

Rock River distinguished and characteristic forging enable the socket to form the concentricity in the center. Besides, the fine structure of the socket is stabilized after heat treating so as to provide the best performance and lower the vibration when air wrench is moving with high speed RPMs.

Series - Hex		
Number of Points 6		
Size	Part No.	
1/4"	2112503	
5/16"	2112504	
3/8"	2112505	
7/16"	2112506	
1/2"	2112507	
9/16"	2112508	
5/8"	2112509	
3/4"	2112510	
H6	2112495	
H8	2112496	
H10	2112497	
H12	2112498	
H14	2112499	
H17	2112500	
H19	2112501	



2112293



2112298



2112304



2112495

Impact Sockets

1/2" Drive Size

Rock River distinguished and characteristic forging enable the socket to form the concentricity in the center. Besides, the fine structure of the socket is stabilized after heat treating so as to provide the best performance and lower the vibration when air wrench is moving with high speed RPMs.

Number of Points: 6		
Series	Standard	Deep
Size	Part No.	Part No.
1/2"	2112280	2112267
9/16"	2112281	2112268
5/8"	2112282	2112269
11/16"	2112283	2112270
3/4"	2112284	2112271
13/16"	2112285	2112272
7/8"	2112286	2112273
15/16"	2112287	2112274
1"	2112288	2112275
1-1/16"	2112289	2112276
1-1/8"	2112290	2112277
1-1/4"	2112291	2112278
10mm	2112447	-
11mm	2112448	-
12mm	2112458	-
13mm	2112449	-
14mm	2112459	-
15mm	2112450	-
16mm	2112460	-
17mm	2112451	-
18mm	2112452	-
19mm	2112453	-
21mm	2112454	-
22mm	2112455	-
24mm	2112456	-
27mm	2112457	-



2112267



2112288



2112280



2112449

Impact Socket Sets

3/8" Drive Impact Socket Sets

Part No.	Number of Pieces	Size	Contents
2112292	8	5/16", 3/8", 7/16", 1/2", 9/16", 5/8", 11/16", 3/4"	(8) Standard Impact Sockets, plastic hanger
2112301	8	5/16", 3/8", 7/16", 1/2", 9/16", 5/8", 11/16", 3/4"	(8) Deep Impact Sockets, plastic hanger
2112279	12	1/2", 9/16", 5/8", 11/16", 3/4", 13/16", 7/8", 15/16", 1", 1-1/16", 1-1/8", 1-1/4"	(12) Standard Impact Sockets, blow case

1/2" Drive Size Deep Impact Socket Set

Rock River distinguished and characteristic forging enable the socket to form the concentricity in the center. Besides, the fine structure of the socket is stabilized after heat treating so as to provide the best performance and lower the vibration when air wrench is moving with high speed RPMs.

Part No.	Number of Pieces	Size	Contents
2112266	12	1/2", 9/16", 5/8", 11/16", 3/4", 13/16", 7/8", 15/16", 1", 1-1/16", 1-1/8", 1-1/4"	(12) Deep Impact Sockets, blow case



2112279



2112266

Stepladders

Fiberglass Step Ladders

Inside spreader braces and wide back braces make this ladder durable and stable to use. Great for a wide variety of tasks.

- Multi-function top with tool and bucket holders
- Wide, non-slip steps
- Spreader braces inside fiberglass rails help keep braces from getting hooked or abused in transit
- Heavy duty rubber boot shoe
- Meets or exceeds the safety standards set by ANSI and OSHA
- Type IA 300 lb work load capacity

Part No.	Overall Height
0233336	2 ft
0233337	4 ft
0233417	6 ft
0233418	8 ft
0233425	10 ft
0233338	12 ft



Extension Ladders

Extension Ladders

- Non-Conductive Fiberglass Type IA 300 lb capacity, "Quick-Latch" safety on rung locks

Part No.	Ladder Size
0233426	24'
0233427	28'



Combination Wrenches

Combination Wrenches

- Chrome Vanadium Steel
- Mirror Finish
- Long Pattern
- Meets ANSI Spec
- 15° offset

Series - Metric	
Wrench Opening	Part No.
7mm	2112112
8mm	2112113
9mm	2112114
10mm	2112115
11mm	2112116
12mm	2112117
13mm	2112118
14mm	2112119
15mm	2112120
17mm	2112121
19mm	2112122

Series - SAE	
Wrench Opening	Part No.
1/4"	2112149
5/16"	2112150
3/8"	2112097
7/16"	2112098
1/2"	2112099
9/16"	2112100
5/8"	2112104
3/4"	2112101
13/16"	2112109
7/8"	2112106
15/16"	2112102
1"	2112110
1-1/8"	2112103
1-1/16"	2112105
1-1/16"	2112107
1-1/4"	2112108

Ratcheting Combination Wrenches

Wrench Opening	Part No.
3/8"	2112124
7/16"	2112125
1/2"	2112126
9/16"	2112127
5/8"	2112128
11/16"	2112129
3/4"	2112130

Reversible Ratcheting Combination Wrenches

Wrench Opening	Part No.
8mm	2112132
10mm	2112133
12mm	2112134
13mm	2112135
14mm	2112136
15mm	2112137
17mm	2112138
19mm	2112139
5/16"	2112141
3/8"	2112142
7/16"	2112143
1/2"	2112144
9/16"	2112145
5/8"	2112146
11/16"	2112147
3/4"	2112148

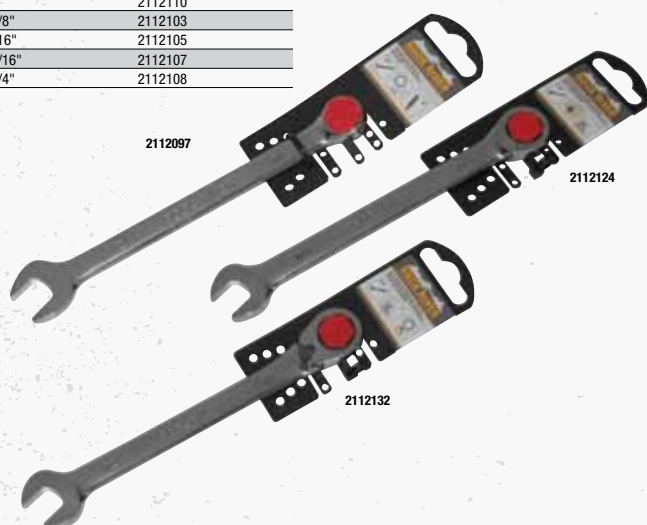

Adjustable Wrenches

Adjustable Wrenches



Overall Length	Handle Type	Part No.
6"	Chrome	2112085
8"	Chrome	2112086
10"	Chrome	2112087
12"	Chrome	2112088
8"	Cushion Grip	2112089
10"	Cushion Grip	2112090
12"	Cushion Grip	2112091

Wrench Sets

Combination Wrench Sets

Part No.	Number of Pieces	Size
2112096	13	1/4", 5/16", 3/8", 7/16", 1/2", 9/16", 5/8", 11/16", 3/4", 13/16", 7/8", 15/16", 1"
2112111	11	7mm - 19mm

Ratcheting Combination Wrenches

Part No.	Number of Pieces	Size
2112123	7	3/8", 7/16", 1/2", 9/16", 5/8", 11/16", 3/4"

Reversible Ratcheting Combination Wrench Sets

Part No.	Number of Pieces	Size
2112131	8	8mm, 10mm, 12mm, 13mm, 14mm, 15mm, 17mm, 19mm
2112140	8	5/16", 3/8", 7/16", 1/2", 9/16", 5/8", 11/16", 3/4"



Hex Keys

Hex Keys

Arm Style - Long	
Key Size	Part No.
1/16"	26509
5/64"	26511
3/32"	26513
7/64"	26515
1/8"	26517
9/64"	26519
5/32"	26521
3/16"	26523
7/32"	26525
1/4"	26527
5/16"	26529
3/8"	26531
7/16"	26533
1/2"	26535
9/16"	26537

Arm Style - Short	
Key Size	Part No.
0.050"	26507
1/16"	26508
5/64"	26510
3/32"	26512
7/64"	26514
1/8"	26516
9/64"	26518
5/32"	26520
3/16"	26522
7/32"	26524
1/4"	26526
5/16"	26528
3/8"	26530
7/16"	26532



Bit Tip Holders

Bit Holder - 1/4 Hex Shank

Part No.	Body Diameter	Overall Length	Model Compatibility
61002	7/16"	3"	1/4" hex inserts



Magnetic Screw Guides

Part No.	Drive	Shank Size	Overall Length
0253812	Hex	1/4" Hex	3"
0253813	Hex	1/4" Hex	6"



Chucks

Heavy Duty Chucks

- Quick Change



Part No.	Chuck Size	Type	Length
0239005	1/4"	Drill Chuck	2.5"
0239006	1/4"	Extension Chuck	3"
0239007	1/4"	Extension Chuck	6"
0239008	1/4"	Extension Chuck	12"

Insert Bit Sets

Impact Insert Bit Packs

Use in power or hand tools with quick-change, keyed or keyless chucks to drive or remove Torx head fasteners/screws.

- Hardened S2 steel for extra long life
- Machined tips are individually inspected to insure specifications and quality
- Plastic storage case fits pockets and tool bags for quick dispensing



0248957

0248958

Part No.	Size	Shank Type	Shank Size	Overall Length	Number of Pieces
0248957	#2 Phillips	Hex	1/4"	1"	15
0248958	#2 Phillips	Hex	1/4"	1"	50
0248959	#2 Phillips	Hex	1/4"	1"	100
0248960	#2 Square	Hex	1/4"	1"	15
0248961	#2 Square	Hex	1/4"	1"	50
0248962	#2 Square	Hex	1/4"	1"	100
0248963	#2 Square	Hex	1/4"	1"	10
0248964	T-25	Hex	1/4"	1"	15
0248965	T-25	Hex	1/4"	1"	50
0248966	T-25	Hex	1/4"	1"	100

Insert Bits

Insert Bit Packs

Insert screwdriver bits in handy storage case. Professional quality.

- Hardened S2 steel for extra long life
- Machined tips are individually inspected to insure specifications and quality
- Plastic storage case fits pockets and tool bags for quick dispensing
- Use in power or hand tools with quick-change, keyed or keyless chucks to drive or remove Torx head fasteners/screws.



0248948



0248949

Part No.	Size	Type	Shank Type	Overall Length
0248946	#2 Phillips	Insert Bit	1/4" Hex	1"
0248947	#2 Phillips	Power Bit	1/4" Hex	2"
0248948	#2 Phillips	Power Bit	1/4" Hex	2"
0248949	#3 Phillips	Insert Bit	1/4" Hex	1"
0248950	#3 Phillips	Insert Bit	1/4" Hex	1"
0248951	#3 Phillips	Power Bit	1/4" Hex	2"
0248952	#3 Phillips	Power Bit	1/4" Hex	2"
0248953	#2 Square	Insert Bit	1/4" Hex	1"
0248954	#2 Square	Insert Bit	1/4" Hex	1"
0248955	T-20	Insert Bit	1/4" Hex	1"
0248956	T-25	Insert Bit	1/4" Hex	1"
0253749	T-7	Power Bit	1/4" Hex	3-1/2"

Insert Bits - Torx



Type - Insert Bit	Part No.	Drive Size	Shank Type	Overall Length
	0200540	T-8	1/4" Hex	1"
	0200541	T-10	1/4" Hex	1"
	0200542	T-15	1/4" Hex	1"
	0200543	T-20	1/4" Hex	1"
	0200544	T-25	1/4" Hex	1"
	0200545	T-27	1/4" Hex	1"
	0200546	T-40	1/4" Hex	1"
	0253742	T-6	1/4" Hex	1"
	0253743	T-7	1/4" Hex	1"
	0253744	T-9	1/4" Hex	1"
	0253745	T-30	1/4" Hex	1"

Type - Power Bit	Part No.	Drive Size	Shank Type	Overall Length
	0253746	T-6	1/4" Hex	1-15/16"
	0253747	T-7	1/4" Hex	1-15/16"
	0253748	T-9	1/4" Hex	1-15/16"
	0253750	T-8	1/4" Hex	3-1/2"
	0253751	T-9	1/4" Hex	3-1/2"
	0253752	T-10	1/4" Hex	3-1/2"
	0253753	T-20	1/4" Hex	3-1/2"
	0253754	T-27	1/4" Hex	3-1/2"
	0253755	T-30	1/4" Hex	3-1/2"
	61502	T-8	1/4" Hex	1-15/16"
	61503	T-10	1/4" Hex	1-15/16"
	61504	T-15	1/4" Hex	1-15/16"
	61505	T-20	1/4" Hex	1-15/16"
	61506	T-25	1/4" Hex	1-15/16"
	61507	T-27	1/4" Hex	1-15/16"
	61508	T-30	1/4" Hex	1-15/16"
	61509	T-40	1/4" Hex	1-15/16"
	61520	T-15	1/4" Hex	3-1/2"
	61522	T-25	1/4" Hex	3-1/2"
	61525	T-40	1/4" Hex	3-1/2"

Hex Drive Insert Bits



Type - Insert Bit	Part No.	Drive Size	Shank Type	Overall Length
	0253756	1/16" Hex	1/4" Hex	1"
	0253757	5/64" Hex	1/4" Hex	1"
	0253758	3/32" Hex	1/4" Hex	1"
	0253759	7/64" Hex	1/4" Hex	1"
	0253760	1/8" Hex	1/4" Hex	1"
	0253761	9/64" Hex	1/4" Hex	1"
	0253762	5/32" Hex	1/4" Hex	1"
	0253763	3/16" Hex	1/4" Hex	1"
	0253764	7/32" Hex	1/4" Hex	1"
	0253765	1/4" Hex	1/4" Hex	1"
	0253766	5/16" Hex	1/4" Hex	1"
	0253767	3/8" Hex	1/4" Hex	1"

Type - Power Bit	Part No.	Drive Size	Shank Type	Overall Length
	0253768	1/16" Hex	1/4" Hex	2"
	0253769	5/64" Hex	1/4" Hex	2"
	0253770	3/32" Hex	1/4" Hex	2"
	0253771	7/64" Hex	1/4" Hex	2"
	0253772	1/8" Hex	1/4" Hex	2"
	0253773	9/64" Hex	1/4" Hex	2"
	0253774	5/32" Hex	1/4" Hex	2"
	0253775	3/16" Hex	1/4" Hex	2"
	0253776	7/32" Hex	1/4" Hex	2"
	0253777	1/4" Hex	1/4" Hex	2"
	0253778	5/16" Hex	1/4" Hex	2"
	0253779	3/8" Hex	1/4" Hex	2"

Slotted Insert Bits



Type - Insert Bit	Part No.	Size	Shank Type	Overall Length
	0253732	#3 - #4	1/4" Hex	1"
	0253733	#4 - #5	1/4" Hex	1"
	61403	#6 - #8	1/4" Hex	1-1/2"
	61404	#8 - #10	1/4" Hex	1-1/2"
	61405	#10 - #12	1/4" Hex	1-1/2"
	61406	#12 - #14	1/4" Hex	1-1/2"
	61407	#14 - #16	1/4" Hex	1-1/2"

Type - Power Bit	Part No.	Size	Shank Type	Overall Length
	0253734	#6 - #8	1/4" Hex	1-15/16"
	0253735	#14 - #16	1/4" Hex	1-15/16"
	0253736	#3 - #4	1/4" Hex	3-1/2"
	0253737	#4 - #5	1/4" Hex	3-1/2"
	0253738	#6 - #8	1/4" Hex	3-1/2"
	0253739	#8 - #10	1/4" Hex	3-1/2"
	0253740	#10 - #12	1/4" Hex	3-1/2"
	0253741	#12 - #14	1/4" Hex	3-1/2"
	61408	#1 - #2	1/4" Hex	1-15/16"
	61409	#2 - #3	1/4" Hex	1-15/16"
	61410	#3 - #4	1/4" Hex	1-15/16"
	61411	#4 - #5	1/4" Hex	1-15/16"
	61415	#8 - #10	1/4" Hex	1-15/16"
	61416	#10 - #12	1/4" Hex	1-15/16"
	61417	#12 - #14	1/4" Hex	1-15/16"

Insert Bits Cont.

Square Insert Bits



Part No.	Size	Shank Type	Overall Length
61150	#0 Square	1/4" Hex	1"
61151	#1 Square	1/4" Hex	1"
61152	#2 Square	1/4" Hex	1"
61153	#3 Square	1/4" Hex	1"
61154	#1 Square	1/4" Hex	1-15/16"
61155	#2 Square	1/4" Hex	1-15/16"
61156	#3 Square	1/4" Hex	1-15/16"
61157	#1 Square	1/4" Hex	2-3/4"
61158	#2 Square	1/4" Hex	2-3/4"
61159	#3 Square	1/4" Hex	2-3/4"
61160	#1 Square	1/4" Hex	3"
61161	#2 Square	1/4" Hex	3"
61162	#3 Square	1/4" Hex	3"
61168	#1 Square	1/4" Hex	6"
61169	#2 Square	1/4" Hex	6"
61170	#3 Square	1/4" Hex	6"

Phillips Insert Bits

- 1/4" Hex Shank with round bodies. Cold formed for optimum toughness and resistance to wear.



Type - Insert Bit			
Part No.	Size	Shank Type	Overall Length
0253730	#0 Phillips	1/4" Hex	1"
61301	#1 Phillips	1/4" Hex	1"
61302	#2 Phillips	1/4" Hex	1"
61303	#3 Phillips	1/4" Hex	1"
61304	#2R Phillips	1/4" Hex	1"

Type - Power Bit			
Part No.	Size	Shank Type	Overall Length
0253731	#0 Phillips	1/4" Hex	1-15/16"
61305	#1 Phillips	1/4" Hex	1-15/16"
61306	#2 Phillips	1/4" Hex	1-15/16"
61307	#3 Phillips	1/4" Hex	1-15/16"
61308	#1 Phillips	1/4" Hex	3-1/2"
61309	#2 Phillips	1/4" Hex	3-1/2"
61310	#3 Phillips	1/4" Hex	3-1/2"
61311	#1 Phillips	1/4" Hex	2-3/4"
61312	#2 Phillips	1/4" Hex	2-3/4"
61313	#3 Phillips	1/4" Hex	2-3/4"
61314	#1 Phillips	1/4" Hex	6"
61315	#2 Phillips	1/4" Hex	6"
61316	#3 Phillips	1/4" Hex	6"

Individual Screwdrivers

Phillips & Slotted Screwdrivers

- Cushion grip handle
- Magnetic tip
- Meets or exceeds ANSI/ASME

Drive - Phillips		
Size	Blade Length	Part No.
#0	3"	2105213
#1	1-1/2"	2105214
#1	3"	2105215
#2	6"	2105216
#2	1-1/2"	2105217
#2	4"	2105218
#2	6"	2105219
#2	8"	2105220
#3	6"	2105221
#00	60mm	2105244
#0	60mm	2105245
#1	60mm	2105246

Drive - Slotted		
Size	Blade Length	Part No.
1/8"	2"	2105198
1/8"	3"	2105199
1/8"	4"	2105200
1/8"	6"	2105201
5/32"	4"	2105202
3/16"	3"	2105203
3/16"	4"	2105204
3/16"	5"	2105205
3/16"	6"	2105206
3/16"	8"	2105207
1/4"	1-1/2"	2105208
1/4"	4"	2105209
1/4"	6"	2105210
5/16"	6"	2105211
3/8"	8"	2105212
1.5mm	60mm	2105240
2mm	60mm	2105241
2.5mm	60mm	2105242
3mm	60mm	2105243



Torx Screwdrivers

- Cushion grip handle
- Magnetic tip
- Meets or exceeds ANSI/ASME

Part No.	Size	Blade Length
2105222	T-5	3"
2105223	T-6	3"
2105224	T-7	3"
2105225	T-8	3"
2105226	T-9	3"
2105227	T-10	4"
2105228	T-15	4"
2105229	T-20	4"
2105230	T-25	4"
2105231	T-27	4"
2105232	T-30	4"

Square Screwdrivers

- Cushion grip handle
- Magnetic tip
- Meets or exceeds ANSI/ASME

Part No.	Size	Blade Length	Color
2105233	#0	4"	Black / Gray
2105234	#1	4"	Black / Gray
2105235	#2	4"	Black / Gray
2105236	#3	4"	Black / Gray
2105237	#1	5"	Green
2105238	#2	5"	Red
2105239	#3	5"	Black



Screwdriver Sets

6 Piece Torx Screwdriver Set

- Cushion grip handle
- Magnetic tip
- Meets or exceeds ANSI/ASME

Part No.	Size	Blade Length
2105261	T10, T15, T20, T25, T27, T30	80mm, 100mm, 125mm, 5"



6 Piece Precision Phillips & Slotted Tip Screwdriver Set

- Cushion grip handle
- Magnetic tip
- Meets or exceeds ANSI/ASME



Part No.	Size	Blade Length
2105262	Slotted: 5/64" x 2", 3/32 x 2", 7/64" x 2"; Phillips: #00 x 2", #0 x 2", #1 x 2"	2"

16 Piece Phillips & Slotted Tip Screwdriver Set

- Cushion grip handle
- Magnetic tip
- Meets or exceeds ANSI/ASME



Part No.	Size	Blade Length
2105263	Slotted 1/8"x2", 1/8"x4", 1/8"x6", 1/4"x1-1/2", 1/4"x4, 1/4"x6", 3/16"x4", 3/16"x6, 5/16"x6; Phillips #2x1-1/2", #1x6", #0x2-1/2", #1x3", #2x4", #2x6", #3x6"	1-1/2", 2", 3", 4", 6"

8 Piece Anti-Slip Grip Phillips & Slotted Tip Screwdriver Set

- Cushion grip handle
- Magnetic tip
- Meets or exceeds ANSI/ASME



Part No.	Size	Blade Length
2105264	Slotted 1/8"x3", 1/8"x4", 3/16"x4", 1/4"x4"; Phillips #1x3", #2x4", #2x1-1/2", #3x6"	1-1/2", 3", 4", 6"

Individual Nut Drivers

Nut Drivers

- Cushion grip handle
- Meets or exceeds ANSI/ASME
- Full hollow shaft

Series - Metric	Drive Size	Shank Length
2105247	5mm	75mm
2105248	6mm	75mm
2105249	7mm	75mm
2105250	8mm	75mm
2105251	9mm	75mm
2105252	10mm	75mm
2105253	11mm	75mm

Series - SAE	Drive Size	Shank Length
2105254	3/16"	3"
2105255	1/4"	3"
2105256	5/16"	3"
2105257	11/32"	3"
2105258	3/8"	3"
2105259	7/16"	3"
2105260	1/2"	3"



Nut Driver Sets

7 Piece Nut Driver Sets

- Cushion grip handle
- Meets or exceeds ANSI/ASME
- Full hollow shaft



Part No.	Drive Size	Shank Length	Style	Drive
2105265	3/16", 1/4", 5/16", 3/8", 7/16", 1/2"	3"	Hollow Shaft	SAE
2105266	5mm, 6mm, 7mm, 8mm, 9mm, 10mm, 11mm	75mm	Hollow Shaft	Metric

Cutting Pliers

Diagonal Pliers



Part No.	Overall Length
2112074	6"
2112075	7"

End Cutting Nipper



Part No.	Overall Length
2112076	8"

Linesman Pliers



Part No.	Overall Length
2112077	8"

Long Nose Pliers



Part No.	Overall Length
2112078	6"
2112079	8"

Adjustable Joint Pliers

Slip Joint Pliers



Part No.	Overall Length
2112080	6"
2112081	8"

Tongue & Groove Joint Pliers



Part No.	Overall Length
2112082	8"
2112083	10"
2112084	12"



Plier Sets

3 Piece Pliers Set

- Cushion grip



Part No.	Number of Pieces	Contents
2112092	3	Long Nose, Diagonal, & Groove Joint Plier Set
2112093	3	Diagonal, Linemans, & Long Nose Plier

2112094



2112095



2112173



4 Piece Pliers Set

Part No.	Number of Pieces	Contents
2112094	4	Groove Joint, Linemans, Long Nose, & Adjustable Plier

5 Piece Pliers Set

- Cushion grip

Part No.	Number of Pieces	Contents
2112095	5	Groove Joint, Linemans, Long Nose, Slip Joint, & Diag Plier
2112172	5	Diagonal, Long Nose, Slip Joint, Groove Joint, & Adj Plier

8 Piece Plier Sets

- Cushion grip

Part No.	Number of Pieces	Contents
2112173	8	7" heavy duty diagonal pliers, 8" cutting nipper, 8" linesman pliers, 8" long nose pliers w/o side cutter, 8" slip joint pliers, 10" groove joint pliers, 10" heavy duty adjustable wrench w/ injection handle, 12" heavy duty adjustable wrench w/ injection handle

Locking Pliers

Curved Jaw Locking Pliers

- Chrome Molybdenum Steel



Part No.	Size
2161700	5"
2161701	7"
2161702	10"

Long Nose Locking Pliers

- Chrome Molybdenum Steel



Part No.	Size
2161705	4"
2161706	6"
2161707	9"

C-Clamps Locking Pliers with Pads

- Chrome Vanadium Steel



Part No.	Size
2161712	6"
2161713	10"
2161714	18"
2161715	24"

Sheet Metal Grip Locking Pliers

- Chrome Molybdenum Steel



Part No.	Size
2161717	8"

Straight Jaw Locking Pliers

- Chrome Molybdenum Steel



Part No.	Size
2161703	7"
2161704	10"

C-Clamps Locking Pliers

- Chrome Vanadium Steel



Part No.	Size
2161708	6"
2161709	11"
2161710	18"
2161711	24"

Locking Pliers with 18" Chain

- Chrome Molybdenum Steel



Part No.	Size
2161716	18"

Welders Grip Locking Pliers

- Chrome Molybdenum Steel Jaw



Part No.	Size
2161718	9"

C Clamps

C-Clamps

- Drop Forged Steel Frame
- Chrome plating spindle



Part No.	Throat Depth	Clamping Capacity	Material
0253007	2-3/4"	4"	Carbon Steel
0253008	3-5/8"	6"	Carbon Steel
0253009	4-1/2"	8"	Carbon Steel
0253010	1-1/16"	1"	Ductile Iron
0253011	1-1/8"	2"	Ductile Iron
0253012	1-1/2"	1-1/2"	Ductile Iron
0253013	2"	3"	Ductile Iron
0253014	2-1/2"	2-1/2"	Ductile Iron
0253015	2-3/4"	4"	Carbon Steel
0253016	3-5/8"	6"	Carbon Steel
0253017	4-1/2"	8"	Carbon Steel

L-Clamps

L-Clamps

- Sliding Arm F Clamp



Part No.	Clamping Pressure	Clamping Capacity	Throat Depth	Overall Length
0253003	2600 lb	10"	4-3/4"	14.10"
0253004	2600 lb	12"	4-3/4"	16.10"
0253005	2600 lb	16"	4-3/4"	20.10"
0253006	2600 lb	20"	4-3/4"	24.00"

Spring Clamps

Plastic Spring Clamps

- Plastic clamps feature a vinyl handle that improves grip performance
- Spring force increased by tempering



Part No.	Size	Overall Length	Material
0249113	1/2"	2.36"	Nylon, Polypropylene
0249114	3/4"	3.54"	Nylon, Polypropylene
0222907	1"	4.72"	Nylon
0222908	2"	6.50"	Nylon
0222909	3"	8.66"	Nylon

16 Pcs Plastic Spring Clamp Set

- Vinyl handle improves the grip performance
- Spring force is increased by tempering
- Includes: 2x3", 2x2", 4x1", 4x3/4", 4x1/2"
- Swivel pads



Part No.	Throat Depth	Overall Length	Material	Contents
0249112	0.95", 1.42", 1.77", 2.76", 3.43"	2.36, 3.54, 4.72, 6.50, 8.66	Nylon, Polypropylene	(16) Piece 1/2", 3/4", 1", 2", 3" Clamps

Steel Spring Clamps

Material - Steel, PVC Handle & Tip

Part No.	Overall Length	Size
0222913	4.13"	1"
0222914	6.30"	2"
0222915	9.06"	3"

Material - Steel, Plain Handle

Part No.	Overall Length	Size
0222910	4.13"	1"
0222911	6.30"	2"
0222912	9.06"	3"



Vises

Vises



Part No.	Jaw Opening	Jaw Width	Capacity
0269146	5-3/4"	6"	1/4" - 3-1/2"
0269147	7-1/2"	8"	1/4" - 3"
0269148	6"	6"	1/4" - 3"
0269149	4"	4-1/2"	1/4" - 2"
0269150	5"	5-1/2"	1/4" - 2-1/2"
0269151	5-1/2"	6-1/2"	1/4" - 2-1/2"

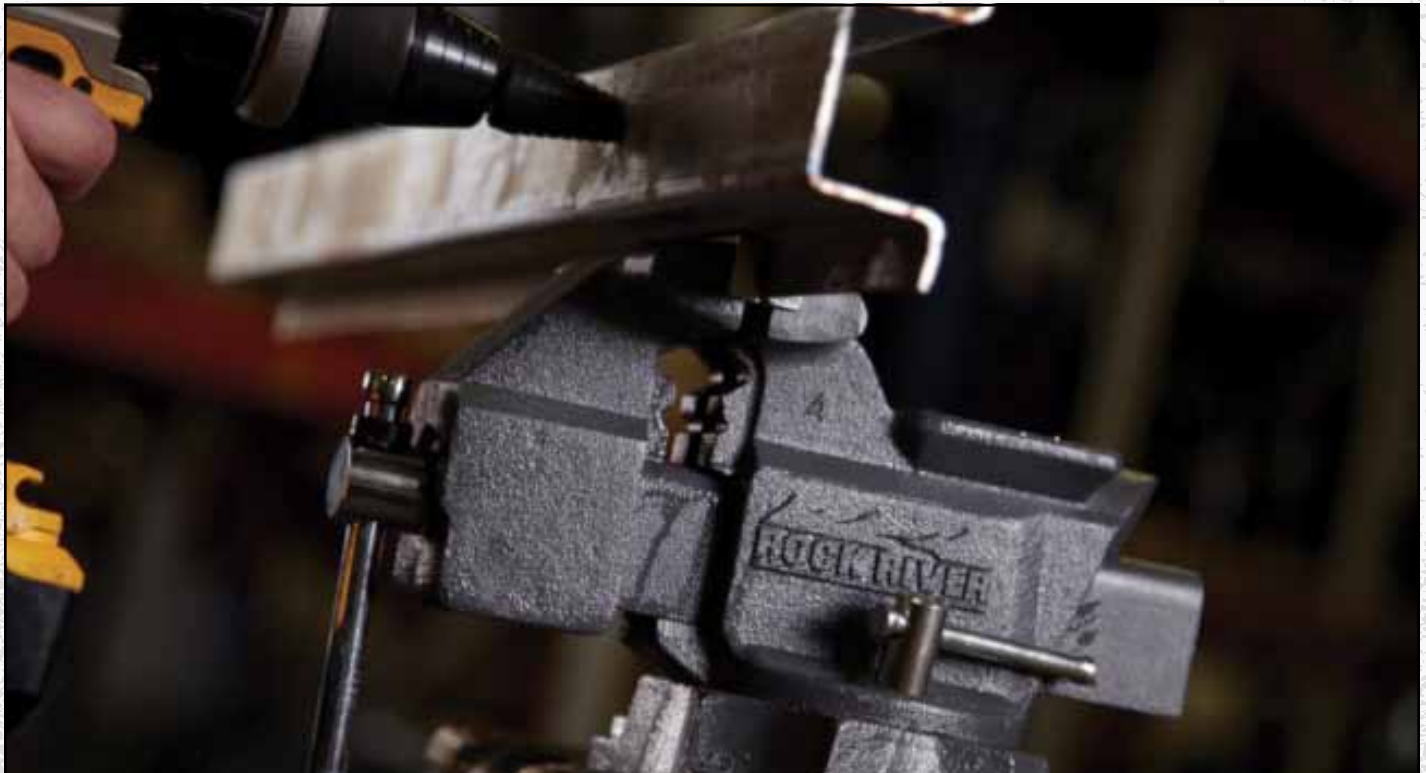

Marking Products

Paint Markers

- Broad chisel tip marks in three stroke widths: 5/16" (8 mm.), 3/16" (4.7 mm.), 1/8" (3 mm.)
- Fast drying, water and weather resistant Xylene-free paint
- Mark on metals, plastics, glass, ceramics, wood and more
- Paint complies with California Prop. 65, RoHS Directive 2002/95/EC and is not reportable under Title III, Sara 313



Series - Individual

Part No.	Color	Tip Style
0205477	Black	Medium Bullet
0205478	White	Medium Bullet
0205479	Yellow	Medium Bullet
0205480	Green	Medium Bullet
0205481	Red	Medium Bullet
0205482	Orange	Medium Bullet
0205483	Blue	Medium Bullet
0205485	Black	Chisel
0205486	White	Chisel
0205487	Yellow	Chisel
0229931	Brown	Fine Bullet
0229932	Pink	Fine Bullet
0229933	Violet	Fine Bullet
0229934	Silver	Fine Bullet
0229935	Gold	Fine Bullet
0229936	Light Blue	Fine Bullet
0229937	Green	Fine Bullet

Series - Sets

Part No.	Color	Tip Style	Drying Time
0205484	Black / White / Yellow / Green / Red / Orange	Medium Bullet	30 sec
0205488	Black / White / Yellow	Chisel	30 sec

Quick Dry Solid Paint Markers

- Smooth-marking, highly visible permanent paint dries in 5 minutes on most surfaces
- Durable plastic holder protects the stick, preventing breakage and allowing full use of marker unlike many paint crayons
- Convenient twist-up knob easily advances and retracts marker
- Made in U.S.A.



Packing	1-Pack	12-Pack
Color	Part No.	Part No.
Black	0237808	0237813
Blue	0237810	0237815
Red	0237809	0237814
White	0237806	0237811
Yellow	0237807	0237812

Carpenter's Pencils

Carpenters Pencil

- Unique shape prevents rolling
- Medium lead can be sharpened easily



Part No.	Length
0218173*	7"

* Not available in Mexico.

Twist-Up Solid Paint Marker

FEATURES & BENEFITS

- Marks on virtually any surface: wet, smooth, rough, or hot
- Fast-drying, vibrant paint dries in 5 to 7 minutes
- Weather- and UV-resistant paint for longlasting mark
- Airtight, self-storing cap keeps the marker clean and fresh between uses
- Marking range: 0°F to 392°F (-18°C to 200°C)



INDUSTRY USES

Metal fabrication
Automotive aftermarket
Construction
Welding
Industrial process piping
Shipping supply

SURFACE USES

Pipes and tubes
Glass
Steel and iron
Ceramic
Lumber and timber
Concrete and stone
Rubber and tires
Plastic

1-Pack	12-Pack	Color
0237808	0237813	Black
0237810	0237815	Blue
0237809	0237814	Red
0237806	0237811	White
0237807	0237812	Yellow



Distributed Exclusively by

FASTENAL



Chalk Refills

Marking Chalk Refills

Brilliant color and easy flow for box fill up.

- Made in USA



Weight	3 lb	8 oz
Color	Part No.	Part No.
Black	-	0256629
Blue	0256642	0256627
Glo-Lime	-	0256633
Glo-Orange	-	0256632
Red	0256641	0256628
White	-	0256630
Yellow	-	0256631



0256627



0256642

Chalk Reels

Chalk Line Reel and Marking Chalk

Metal Chalk Line Reel



Part No.	Length	Color
0256622	100 ft	Silver



Part No.	Length	Case Style
0256621	100 ft	Metal

NEVER REPLACE A HAMMER AGAIN!

**INDESTRUCTIBLE HANDLE HAMMERS
OUTLAST WOOD & FIBERGLASS HANDLE
HAMMERS BY THOUSANDS OF STRIKES!**

**WE STOPPED
COUNTING
AFTER
36,000
STRIKES**

**FIBERGLASS
HANDLE BROKE IN
7,000
STRIKES**

**WOOD HANDLE
BROKE IN
450
STRIKES**



ROCK RIVER

Individual Hammers

Hammers

- Drop Forged Hammer Head from Selected Steel/ Non-slip Handle Grips



Type - Ball Pein Hammer				
Part No.	Head Weight	Handle Length	Handle Material	Head Material
0225249	8 oz	11"	Fiberglass	Carbon Steel
0225250	16 oz	13"	Fiberglass	Carbon Steel
0225251	24 oz	15"	Fiberglass	Carbon Steel
0225252	32 oz	15"	Fiberglass	Carbon Steel
0249118	8 oz	11"	Wood	Forged Steel
0249119	12 oz	11"	Wood	Forged Steel
0249120	16 oz	12"	Wood	Forged Steel
0249121	24 oz	14"	Wood	Forged Steel
0249122	32 oz	14"	Wood	Forged Steel

Type - Claw Hammer				
Part No.	Head Weight	Handle Length	Handle Material	Head Material
0249129	16 oz	11"	Fiberglass	Forged Steel

Type - Dead Blow Hammer				
Part No.	Head Weight	Handle Length	Handle Material	Head Material
0249115	37 oz	12"	Rubber	Steel / Rubber
0249116	18 oz	10"	Rubber	Steel / Rubber
0249117	52 oz	12"	Rubber	Steel / Rubber

Type - Drilling Hammer				
Part No.	Head Weight	Handle Length	Handle Material	Head Material
0225253	3 lb	11"	Fiberglass	Carbon Steel

Type - Ripping Hammer				
Part No.	Head Weight	Handle Length	Handle Material	Head Material
0249128	16 oz	11"	Fiberglass	Forged Steel
0249130	16 oz	11"	Wood	Forged Steel
0249131	16 oz	11"	Wood	Forged Steel

Sledge Hammers

Fiberglass Handle Sledge Hammer



Type - Sledge Hammer			
Part No.	Head Weight	Handle Length	Head Material
0249123	4 lb	14"	Forged Steel
0249124	8 lb	32"	Forged Steel
0249125	14 lb	32"	Forged Steel
0249126	10 lb	32"	Forged Steel
0249127	12 lb	32"	Forged Steel

Sledge Hammers Cont.

Indestructible Handle Sledge Hammers

Indestructible handle is made with spring steel bars that run all the way through the handle. Bars are locked with the hammer head using steel locking plates ensuring that the head never gets dislodged

- Special bonding process ensures that head never gets loose from the handle



Part No.	Head Weight	Handle Length	Head Material
0229833	2.5 lb	12"	Steel
0229834	4 lb	12"	Steel
0229835	4 lb	16"	Steel
0229837	6 lb	24"	Steel
0229838	6 lb	30"	Steel
0229839	8 lb	24"	Steel
0229840	8 lb	30"	Steel
0229841	10 lb	30"	Steel
0229842	12 lb	30"	Steel
0229843	14 lb	30"	Steel

Individual Hammers

Copper Head Indestructible Handle Sledge Hammer

- Hammer head is forged from 99.9% pure copper for spark free use
- Copper head resists sparking & reduces marring of most struck surfaces



Part No.	Head Weight	Handle Length	Head Material
0229836	4 lb	12"	Copper
0229844	8 lb	24"	Copper
0229845	14 lb	30"	Copper

Indestructible Handle Cross Pein & Ball Pein Hammers

- Hammer Head is forged from special steel & is Induction case hardened to 52 to 56 HRC for extended life

Applications: bending & shaping metal, driving punches & chisels, concrete & stone work, hand forging, setting rivets, peen riveted & welded materials, texturing face of metal



Part No.	Head Weight	Handle Length	Type
0229846	2.5 lb	16"	Cross
0229847	3.5 lb	16"	Cross
0229850	24 oz	14"	Ball
0229853	32 oz	14"	Ball

Individual Pry Bars

Goose Neck Wrecking Bar

- Hardened and Tempered
 - Powder painted
- Used to Pry and move heavy objects



Part No.	Overall Length	Tip Width
0226718	36"	1-1/4"

Crow Bars

Used to pry and move heavy objects

- Drop forged from select carbon steel
- Hardened and tempered ends
- Square round shank
- Powder painted polished tips with medium carbon steel

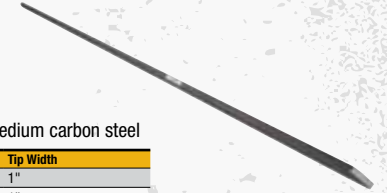

Part No.	Overall Length	Tip Width
0226719	60"	1"
0226720	48"	1"

Pry Bars

Flat Utility Pry Bars



Part No.	Length
0228721	13"
0228722	15"

Bolt Cutters

Bolt Cutters

CrMo steel blade. Could adjust cutting edge by the bolts on head.

Drop-forged adapter. Cutting ability maximum: HRC40.

Shear all kinds of metal wire rod or diameter smaller cylindrical workpiece



Part No.	Overall Length	Medium Capacity	Soft Capacity
2112197	14"	5mm	7mm
2112198	18"	6mm	8mm
2112199	24"	8mm	10mm
2112200	30"	10mm	13mm
2112201	36"	12mm	16mm
2112202	42"	14mm	19mm

Hacksaw Frames

Hacksaw Frames



Part No.	Blade Length	Description
0225254	12"	Heavy Duty, High Tension
0225255	12"	Quick Change, High Tension

Hack Saw Blades

12" Hacksaw Blades



Part No.	Model No.	Teeth Per Inch
0207227	03991	18
0207228	03992	24
0207229	03993	32

Scissors, Snips, & Shears

Snips



Part No.	Length of Cut	Material	Overall Length	Cut Type	Type	Maximum Capacity
0227425	1.3779"	Chrome Molybdenum Alloy Steel	9.7637"	Left	Aviation Snips	22 Gauge
0227426	1.3779"	Chrome Molybdenum Alloy Steel	9.7637"	Right	Aviation Snips	22 Gauge
0227427	1.4960"	Chrome Molybdenum Alloy Steel	9.8425"	Straight	Aviation Snips	22 Gauge
0227428	0.9842"	Chrome Molybdenum Alloy Steel	9.2519"	Straight	Bulldog Snips	18 Gauge
0227429	1.1811"	Chrome Molybdenum Alloy Steel	9.6456"	Left / Straight	Tinner Snips	22 Gauge
0227430	1.1811"	Chrome Molybdenum Alloy Steel	9.6456"	Right / Straight	Tinner Snips	22 Gauge
0227431	2.9527"	Chrome Molybdenum Alloy Steel	11.4173"	Straight	Tinner Snips	28 Gauge
0227432	1.9685"	High Carbon Steel	10.5511"	Straight	Tinner Snips	26 Gauge
0227433	2.7559"	High Carbon Steel	12.2834"	Straight	Tinner Snips	26 Gauge
0227434	1.5748"	High Carbon Steel	7.0866"	Straight	Tinner Snips	28 Gauge

Tape Measures

Tape Measures

High quality tape measures that feature high precision and even return speeds.



Measurement System - English			
Part No.	Blade Length	Blade Width	Case Color
0254453	16 ft	3/4"	Black
0254454	25 ft	1"	Black
0254455	16 ft	3/4"	Chrome
0254456	25 ft	1"	Chrome
0254451	30 ft	1"	Chrome

Measurement System - English / Metric			
Part No.	Blade Length	Blade Width	Case Color
2112575	5 M	19mm	Black
2112576	7.5 M	25mm	Black
2112577	5 M	19mm	Chrome
2112578	7.5 M	25mm	Chrome

Calibrated Power Return Tape Measures

Fastenal calibration certified. Certificate of calibration included.

- Thicker 60 Carbon steel tape, long use time
- ABS chrome plated case with slide lock and clip



Part No.	Blade Width	Blade Length	Style
0228042	25mm	7.5 M	Power Return
0228043	25mm	7.5 M	Power Return

Squares

Combination Squares

Powder coated combination square with 1/8", 1/16", 1/32" graduations for precise measuring. Combination head includes self-aligning drawbolt for secure placement, 90° and 45° angles and hardened scriber.



Part No.	Length
0267634	12"

Batteries

Alkaline Batteries

- Long lasting power
- No added mercury



Battery Size	Pkg. Qty.	Part No.	Pkg. Qty.	Part No.
AAA	24	0225011	4-Pack	0224302
AA	24	0225010	4-Pack	0224301
C	12	0225008	2-Pack	0224303
D	12	0225009	2-Pack	0224304
9V	12	0225012	2-Pack	0224305

Flashlights

LED Flashlights

- Long lasting CREE LED
- Durable aluminum body



Part No.	Wattage	Battery Size	Number of Batteries Required
0211555	1.00	AA	3
0211557	3.00	D	3
1047965	3.00	AAA	3

Utility Knives

Folding Utility Knives



Part No.	Handle Material	Length
0248015	Nylon	6-1/2"
0248016	Aluminum	6.1"
0248017	Stainless Steel	6.7"

Retractable Utility Knives



Part No.	Blade Style	Length
0209246	Retractable	6.81"
0209250	Retractable	6.02"
0265827	Retractable	8.47"

Utility and Safety Blades



Part No.	Number of Blades	Style
0265825	5	Rounded
0265829	5	Hook
0265826	5	Utility Blade
0209257	10	Utility Blade
0209256	100	Utility Blade

Utility Knives

Snap Knives

- 9mm blade

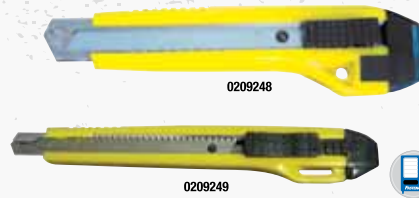

Part No.
0209248
0209249

Replacement Snap Blades



Part No.	Number of Blades	Compatible Knife
0209253	10	0209248
0209254	10	0209249

Utility Knives

Handy Cutter



Part No.	Length	Blade Style
0209251	3.90"	Retractable

Heavy Duty Steel Paint And Glass Scraper



Part No.	Blade Length	Blade Width	Blade Material
0222948	0.748"	1-1/2"	Steel

Replacement Blades for Handy Cutter & Scraper



Part No.	Number of Blades
0265828	10
0209255	100

Foam & Film Round Blade Safety Cutter

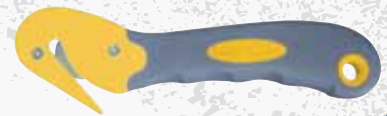

Part No.	Description	Qty.
0209252	Safety Cutter	1
0259071	Replacement Blades	3

Utility Knives

Concealed Blade Safety Carton Opener

Cut foam, stretch wrap, string, ribbon and twine



Part No.	Handle Material	Length
0265830	Plastic	0.69"

Mirrors

Inspection Mirrors



Part No.	Size	Shape	Arm Length
0267363	1-1/4"	Oval	8"
0267364	2" x 3-1/2"	Rectangular	11-1/2" - 16"
2112251	2-1/4"	Oval	10-1/2" - 15"

Folding Knives

Folding Knives



Part No.	Blade Style	Overall Length
0204784	Serrated	3"
0218045	Fine Edge	3.5"
0218046	Fine Edge	3"
0218047	Serrated	3"
0218048	Serrated	3.5"
0218049	Fine	2.5"



0218047



0204784



0218045



0218046



0218048

Multi-Tools

Industrial Multi-Tools



0218040



0218041



0218042



0218043



0218044



Part No.	Contents	Overall Length
0218040	Needle-Nose Pliers, 2.5" Fine Edge Blade, 2.5" Serrated Edge Blade, Bottle Opener with Medium Screwdriver, Large Screwdriver, Small Screwdriver, Adapter, Can Opener, Bottle Opener, Phillips screwdriver, 2.5" Saw	7.25"
0218041	Needle-Nose Pliers, Fine Edge Blade, Serrated Edge Blade, Bottle Opener with Medium Screwdriver, Large Screwdriver, Small Screwdriver, Adapter, Can Opener, Bottle Opener, Phillips Screwdriver, Saw	6.30"
0218042	Blunt-Nose Pliers, Phillips Screwdriver, Bottle Opener, Fine Edge Blade, Screwdriver, File with Ruler, Serrated Edge Blade	6.25"
0218043	Blunt-Nose Pliers, Scissors, Phillips Screwdriver, Bottle Opener, File with Ruler, Screwdriver	6.25"
0218044	Needle-Nose Pliers, Nail File, 1-1/2" Blade, Phillips Screwdriver, Bottle Opener with Screwdriver, 1-1/2" Serrated Blade, Small Screwdriver, Can Opener, Middle Screwdriver	6.30"

Part No. 0220731 Hunter's Combo Gift Set Incl. Thermos, Knife, and Head Lamp

- 25oz Shotgun Shell Thermos
- LED Head Lamp with Batteries
- Camo Knife with Belt Cutter
- Window Breaker
- 4" Stainless Steel Blade



- 25 oz. (3 cup) capacity
- On-touch stopper



- On/Off Switch
- Panel Swivels 50
- 3W LED
- Uses 3 "AAA" Cell Batteries (included)



- Ambidextrous Thumb Studs
- Belt Cutter
- Black Finished
- Liner Lock / Release
- 4" Stainless Steel Blade



Part No. 0220732 Multi-tool and Tape Measure Combo Gift Set

- 11-Function Multi-Tool
- 25' Rubber Coated Tape Measure



- Needle Nose Plier
- Long Nose Plier
- Saw
- Wire Cutter
- Fine Edge Blade
- Medium Slotted Screwdriver
- Drop Point Blade
- 2 Files / Large Screwdriver
- Can and Bottle Opener
- Phillips Screwdriver
- Small Slotted Screwdriver



- Rubber coated for grip and shock resistance
- Multi-colored blade with stud markings
- Push button speed brake
- Rubber bumper absorbs blade shock
- Long-lasting double riveted blade

Warning: Always Wear Safety Goggles.

• **Caution!** Blade is extremely sharp; handle with care.

California Propositions 65 Warning This product contains chemicals known to the State of California to cause cancer, birth defects, or other reproductive harm.

Distributed Exclusively by **FASTENAL**

Putty Knives

Putty Knives

Blade Type - Chisel			
Part No.	Width	Type	Blade Material
0222955	1-1/4"	Putty Knife	Carbon Steel
0222959	3"	Putty Knife	Carbon Steel

Blade Type - Chisel / Stiff			
Part No.	Width	Type	Blade Material
0222956	1-5/16"	Putty Knife	Carbon Steel

Blade Type - Flexible			
Part No.	Width	Type	Blade Material
0222960	1-1/4"	Putty Knife	Carbon Steel
0222961	1-1/2"	Putty Knife	Carbon Steel
0222962	2"	Putty Knife	Carbon Steel
0222964	4"	Joint Knife	Carbon Steel
0222965	6"	Joint Knife	Carbon Steel

Blade Type - Stiff			
Part No.	Width	Type	Blade Material
0222954	1-1/4"	Putty Knife	Carbon Steel
0222957	1-1/2"	Putty Knife	Carbon Steel
0222958	2"	Putty Knife	Carbon Steel

Brass Stiff Putty Knives with Polypropylene Handle

Non-sparkling & non-magnetic blade, made of solid brass w/ fully hardened & mirror polished. Chisel edged blade is softer than steel for scraping sensitive work piece. Full tang construction.

- For use in hazardous environment
- Non sparking solid brass blade is magnetic free, corrosion-resisted, and will not damage sensitive work
- Full tang construction
- Solid brass blade is fully hardened, mirror polished, and well coated

Use to remove paint, grease, undercoating, gaskets, gaskets, etc. For sensitive and hazardous environment. Also good for auto repair and mechanics use.

Part No.	Width	Type	Blade Type
0222949	1-1/4"	Putty Knife	Stiff
0222950	2"	Putty Knife	Stiff
0222951	3"	Scraper	Stiff



Stainless Steel Flexible Putty Knife With Polypropylene Handle

- Professional quality
- Full tang construction
- Heat-treated, clear lacquer coated and mirror polished blades
- Precision ground and tapered
- High quality Stainless Steel 420 blade
- Comfortable Polypropylene handle

Professional quality for home improvement, painting, auto body repair, etc. Use to remove paint, rust, grease, undercoating, and filler. Use to apply adhesive, filler, body/drywall compound, and spackle.

Blade Type - Flexible		
Part No.	Width	Type
0222966	1-1/2"	Putty Knife
0222967	3"	Scraper
0222968	6"	Putty Knife

Blade Type - Stiff		
Part No.	Width	Type
0222969	1-5/16"	Putty Knife
0222970	1-1/2"	Putty Knife

Scrapers

Painters Tool

10 functions for multiple use. An ergonomic designed and durable construction putty knife with two kinds of plastic material & dual color cushion handle. Superior quality with fully hardened, mirror polished blade, Duragrip handle w/ rugged polypropylene handle core and heavy duty hammer end.

- An ergonomic designed and durable construction patented putty knife
- 10 functions for users' application
- Superior quality blade with fully hardened and mirror polished
- TPR soft-grip & ergo-engineered handle absorbs shock & reduces worker fatigue
- Built-in striking hammer end to set drywall nails
- Good for professional and DIY users

Patented ergonomic designed putty knife with 10 functions.

1. Cleans paint rollers
2. Opens paint cans
3. Spreads
4. Scrapes
5. Cleans out cracks
6. Set Drywall Nails
7. Nail Puller
8. Concave scraper
9. Convex scraper
10. Bottle opener



Part No.	Blade Length	Blade Width	Blade Material
0222952	3.89"	3"	Carbon Steel
0222953	3.40"	2-1/2"	Carbon Steel

Rubber Bottom Extreme Backpack Tool Organizer

- 12"x16" size
- Durable polyester construction
- 30 Convenient pockets

This large backpack style bag is a great way to keep your tools organized.

With 30 pockets there is room for just about everything you need to get the job done.

Part #0284759

• Tools Sold Separately



Soft Tool Storage

Tool Bags and Pouches

Multi-style tool bags, pouches, and aprons for any construction or carpentry job.



Series - Tool Bags						
Part No.	Number of Pockets	Type	Material	Width	Length	Description
0225005	12	Apron	Suede	24"	15"	Tool Belt Apron
0258472	20	Tool Bag	Polyester	8-1/4"	8-5/8"	Electrician's Tote
0258473	13	Tool Bag	Polyester	12"	16"	Rubber Bottom Tool Bag
0258475	42	Tool Bag	Polyester	9"	20"	Open Top Tool Organizer
0258478	57	Tool Bag	Polyester	11"	16-3/4"	Folding Chair Tool Bag
Series - Tool Holders						
Part No.	Number of Pockets	Type	Material	Width	Length	Description
0258470	3	Tool Pouch	Polyester	3-1/2"	10-1/4"	Storage Bag
0258480	11	Tool Roll	Polyester	1-1/2"	15-1/2"	Wrench Roll Case Organizer
Series - Tool Pouch & Organizers						
Part No.	Number of Pockets	Type	Material	Width	Length	Description
0258469	0	Tool Belt	Ballistic Nylon	2"	52"	Belt
0258471	4	Apron	Polyester	8-1/4"	8-5/8"	Full Length Tool Apron
0258476	17	Bucket Organizer	Polyester	17-1/4"	22-3/8"	Bucket Organizer
0258479	1	Bucket Organizer	Canvas	11-1/2"	11-1/2"	Bucket Organizer

Tool Boxes

Hand Tool Boxes

- Full width cover hinge
- Moveable tray for convenient storage
- Moveable tray for convenient storage

Part No.	Length	Width	Height
0269126	20"	8-5/8"	9-7/16"
0269130	26-7/16"	8-5/8"	9-1/2"
0269134	24"	8-5/8"	9-5/8"



Tool Chests

Portable Tool Boxes

- Smooth action drawer slides
- Full width cover hinge
- 0269128 has an independently locking security drawer

Part No.	Length	Depth	Height
0220013	17"	9"	10-3/4"
0220014	21"	8"	13"
0269128	20-1/2"	8-5/8"	14"



Tool Boxes

Heavy Duty Plastic Tool Box

- Lockable
- 0269145 has 3 steel drawers

Part No.	Width	Length	Height
0269141	17"	9-1/4"	9"
0269142	20"	9-1/4"	9"
0269143	23"	10-1/4"	10"
0269144	26"	10-1/4"	10"
0269145	23"	10-3/8"	13-1/2"



Tool Chests

- Ball bearing drawer slides provide a smooth action slide
- Heavy-Duty construction adds the needed durability for industrial applications

Roller Cabinet Tool Chests

Part No.	Width	Depth	Height	Number of Drawers	Compatibility
0220012	26"	18"	29"	6	0220011, 0220016
0220017	26"	18"	39"	7	0220015
0269135	28-1/2"	18-1/2"	40-1/2"	9	Coming Soon!
0220019	42"	18"	39-1/2"	7	0220018
0269132	42"	18"	41-1/2"	12	0269133

Top Storage Tool Chests

Part No.	Width	Depth	Height	Number of Drawers	Compatibility
0220011	26"	12-1/2"	14-3/4"	6	0220012
0220015	26"	12"	14-3/4"	4	0220017
0220016	26"	12-1/2"	10-1/2"	3	0220011, 0220012
0220018	42"	17-1/2"	22"	10	0220019
0269133	42"	18"	22-1/4"	7	0269132

Side Storage Tool Chests

Part No.	Width	Depth	Height	Number of Drawers
0269138	16-3/4"	18"	33-1/4"	6
0269139	16-3/4"	18"	33-1/4"	2 Shelves

Service Cart Tool Chest

Part No.	Width	Depth	Height	Number of Drawers
0225938	30"	19-1/4"	41-1/4"	4



0269132



0269133



0269138



0269139



0225938

Jobsite Storage Boxes

Jobsite Storage Boxes

- Optional caster set available (0238799)
- 14-gauge steel construction
- Includes handles on each side for easy lifting

Part No.	Width	Depth	Height	Capacity
0208000	36"	17"	21-1/4"	7 Cubic Feet
0208001	48"	24"	28-1/4"	18 Cubic Feet
0208057	60"	24"	28-1/4"	23 Cubic Feet
0219287	30"	16"	12"	3 Cubic Feet

Jobsite Storage Box Caster Set

- 5" Caster Set includes two rigid casters and two swivel casters

Part No.	Model Compatibility
0238799	0208000, 0208001 and 0208057



0219287



0238799



0208001

Jobsite Storage Boxes

Piano Box

Piano Box has 48 cubic feet of flexible storage space. Heavy-loads can be stored on the two full-length shelves. The bottom shelf tilts up for easier access to load bulky items. Deep, wide bolsters and a 12-gauge steel bottom flange add incredible strength to the door. Wide flanges reinforce the body to resist bending. Bolt Cutter Proof Locking System protects the padlocks (not included) inside 12-gauge steel housings. Only the bottoms of the padlocks are exposed. They can not be cut, pulled or pried out.

- Two gas springs assist with opening and closing the door.
- Lifting handles are protected inside tall, deep recesses to prevent pinched knuckles and damage.
- Tall bottom bolsters for easily moving a loaded Piano Box with a forklift.
- Made in USA

Part No.	Width	Depth	Height	Capacity
0219289	60"	30-1/2"	50"	48 Cubic Feet



Shovels

Shovels



Type - Round Point Shovel

Part No.	Handle Material	Handle Length	Handle Type
0204516	Fiberglass	48"	Straight
0204520	Fiberglass	27"	D-Grip
0254530	Ash Wood	48"	Straight
0254532	Ash Wood	27"	D-Grip

Type - Square Point Shovel

Part No.	Handle Material	Handle Length	Handle Type
0204515	Fiberglass	48"	Straight
0204519	Fiberglass	27"	D-Grip
0254531	Ash Wood	48"	Straight
0254533	Ash Wood	27"	D-Grip

Premium Grade Shovels



Part No.	Handle Length	Type	Handle Material
0204517	48"	Square Point Shovel	Fiberglass
0204518	48"	Round Point Shovel	Fiberglass

Scoop Shovels



Part No.	Handle Length	Handle Material	Blade Material
0254477	29"	Ash Wood	Aluminum
0254527	29"	Polyethylene	Polyethylene
0254534	29"	Fiberglass	Aluminum

Spades

Round Point Drain Spade

16" Drain Spade

- For digging and clearing drainage ditches
- 16" Closed-back industrial gauge tempered steel blade with forward turned step
- 29" Ash wood handle with steel and wood D-Grip

Part No.	Handle Length	Blade Length
0254597	29"	16"

Post Hole Diggers

Post Hole Diggers

Ideal for digging post holes in tilled soil. Tempered Steel blades are strong and durable. Ash wood handles for strength.

- Tempered steel blades
- Best for digging deep holes for posts and footings in hard rocky soil

Part No.	Point Spread	Handle Length	Blade Length	Handle Material
0250833	5-1/2"	48"	8-1/4"	Ash
0250834	5-1/2"	48"	8-1/4"	Fiberglass



Rakes

Leaf Rakes

30 inch width poly head, 48" hardwood handle
Use for raking light materials such as leaves, twigs, and lawn clippings.

Part No.	Head Width	Head Material	Handle Length	Handle Material
0250910	23"	Steel	48"	Ash Wood
0250911	30"	Polypropylene	54"	Hardwood

Rakes

Part No.	Head Material	Head Width	Type
0254612	Steel	15-3/4"	Rake
0254613	Steel	13-3/4"	Rake

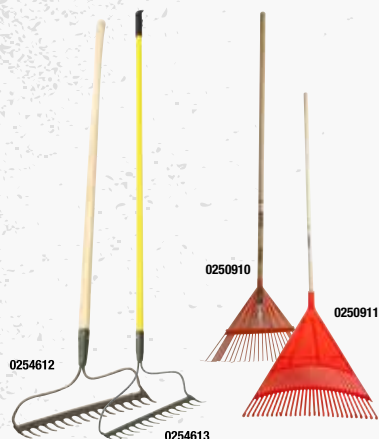

Pitch Forks

Pitch Forks

For digging manure and similar materials during agricultural and landscaping activities.

Part No.	Number of Tines	Handle Length	Handle Material	Style	Width
0250912	5	28.9"	Ash Wood	Manure	8.86"
0250913	6	48"	Ash Wood	Manure	9.84"

Ice Scrapers

Sidewalk Ice Scraper

Part No.	Handle Material	Blade Material
0254478	Ash Wood	Steel

Hoes

Hoes

Part No.	Handle Length	Handle Material	Blade Material
0254614	54"	Fiberglass	Steel
0254615	48"	Ash	Steel



Wheelbarrows

Wheelbarrows



Part No.	Tray Material	Handle Material	Tray Size	Wheel Type	Weight
0256646	Steel	Wood	6 Cubic Feet	Pneumatic	46 lb
0256647	Steel	Steel	6 Cubic Feet	Flat Free	40.26 lb
0297074	Polypropylene	Wood	8 Cubic Feet	Rubber	40 lb



Compressors

Air Compressors

- UL CSA Certified



Part No.	Tank Size	Horsepower	Voltage	Max Air Pressure	Air Consumption	Height	Width
0289718	60 gal	3.7	240	135 psi	11.5 cfm at 90 psi	70"	27"
0289719	80 gal	7.5	240	175 psi	21.2 cfm at 175 psi	79"	29"



0289718



0289719

PORTABLE GENERATORS

Refer to owner's manual for specifications/suggestions on battery replacement



0239061 6.5 HP ROCK RIVER PORTABLE GENERATOR

Engine Displacement: 389 cc
Fuel Type: Gasoline
Run Time: 11.0 hr
Speed: 3600 rpm
Voltage: 120



0239062 7500W 13 HP ROCK RIVER PORTABLE GENERATOR WITH ELECTRIC START

120 V outlet = 60 amps
240 V outlet = 30 amps
Engine Displacement: 389 cc
Fuel Type: Gasoline
Run Time: 10.5 hr
Speed: 3600 rpm



Distributed Exclusively by **FASTENAL**

4 GALLON

Part No. 0617195

Easy to Carry, Transport and Store

Specifications:

- 5.0 Peak HP
- 20' Power Cord

1-7/8" Accessories:

- 7' Locking Hose
- Car Nozzle
- Muffler/Diffuser

Filtration:

- QwikLock™ Pleated Paper Filter & Dust Bag



9 GALLON

Part No. 0617200

Offers More Power and Drum Capacity Than the 6 Gallon, But is Still Compact in Size

Specifications:

- 3.5 Peak HP
- 10' Power Cord

1-7/8" Accessories:

- 7' Locking Hose
- 2 Extension Wands
- Utility Nozzle
- Wet Nozzle

Filtration:

- QwikLock™ Pleated Paper Filter & Dust Bag



4.5 GALLON

Part No. 0617196

Hinged Compartments for Self Contained Accessory Storage

Specifications:

- 5.0 Peak HP
- 20' Power Cord
- Hinged Compartments for Self Contained Accessory Storage
- Stores neatly in any truck or garage

1-7/8" Accessories:

- 2'-7' Expandable Locking Hose
- 2 Extension Wands
- Utility Nozzle
- Crevice Tool
- Dusting Brush

Filtration:

- QwikLock™ Pleated Paper Fine Dust Filter & Dust Bag



12 GALLON

Part No. 0617197

The Ultimate Combination of Performance, Drum Capacity & Convenience. Perfect for Messes Large and Small.

Specifications:

- 5.0 Peak HP
- 15' Power Cord

2-1/2" Accessories:

- 7' Dual Flex Locking Hose
- 2 Extension Wands
- Utility Nozzle
- Car Nozzle
- Wet Nozzle
- Locking Sleeve

Filtration:

- QwikLock™ Pleated Paper Filter & Dust Bag



6 GALLON

Part No. 0617199

A Great Utility Vac for Any Clean Up With Compact Size for Easy Storage

Specifications:

- 2.5 Peak HP
- 10' Power Cord

1-7/8" Accessories:

- 7' Locking Hose
- 2 Extension Wands
- Utility Nozzle

Filtration:

- QwikLock™ Pleated Paper Filter & Dust Bag



16 GALLON

Part No. 0617198

Largest and Most Powerful Motor & Biggest Capacity For Someone Who Needs to Get the Job Done Fast & Efficient.

Specifications:

- 6.5 Peak HP
- 20' Power Cord

2-1/2" Accessories:

- 7' Dual Flex Locking Hose
- 2 Extension Wands
- Utility Nozzle
- Car Nozzle
- Wet Nozzle
- Locking Sleeve

Filtration:

- QwikLock™ Pleated Paper Filter



WET/DRY VACS

ALL-PURPOSE
UTILITY
CLEANING

PORTABLE & COMPACT

6 GALLON

Part No. 0617199



9 GALLON

Part No. 0617200



4 GALLON

Part No. 0617195



12 GALLON

Part No. 0617197



16 GALLON

Part No. 0617198



4.5 GALLON

Part No. 0617196



ADDITIONAL ACCESSORIES AVAILABLE FOR THE ROCK RIVER LINE OF WET/DRY VACS

PART NO.	DESCRIPTION	COMPATIBLE WITH
0617202	2-1/2" x 7' Locking Hose	0617197, 0617198
0617203	1-7/8" x 7' Contractor Hose	0617195, 0617199, 0617200
0617204	1-7/8" x 10' Contractor Hose	0617199, 0617200, 0617197, 0617198
0617205	1/2 Height Fine Dust Filter	0617195, 0617196
0617206	Standard Filter	0617199, 0617200, 0617197, 0617198
0617207	Fine Dust Filter	0617199, 0617200, 0617197, 0617198
0617208	HEPA Media Filter	0617199, 0617200, 0617197, 0617198

DRY ONLY VACS

6 QUART BACKPACK VACUUM

Part No. 0617209

Specifications:

- 115 CFM
- 744 Watt / 6.2 Amp
- 65" Static Lift
- 68 dBA
- Kit includes Floor Tool, 1-1/2" Wand, Upholstery Tool, Dust Brush and Crevice Too



6 QUART HEPA BACKPACK VACUUM

Part No. 0617210

Specifications:

- 150 CFM
- 1,188 Watt / 9.9 Amp
- 100" Static Lift
- 67 dBA
- Kit includes Floor Tool, 1-1/2" Wand, Upholstery Tool, Dust Brush and Crevice Tool
- HEPA certified for fine filtration



Power & Capacity
PERFORMANCE
SERIES

POWERFUL, DURABLE & HIGH PERFORMANCE

Special Features & Versatility
SPECIALTY
SOLUTIONS

UNIQUE FOR
ADDITIONAL
VERSATILITY

Distributed Exclusively by **FASTENAL**

WE SELL LADDERS



Inside spreader braces are inside fiberglass rails to help keep braces from getting hooked or abused in transit.



Large head, dual rivets provide added strength.



Dual bracing for additional solidity and durability while in use, or in transit.



Multi-Function top with tool and bucket holders.



Heavy-duty gusset bracing adds to the stability and the comfort of use.



Wide, non-slip steps add steadiness to every step you take.

0233417

Fiberglass Step Ladders

Inside spreader braces and wide back braces make this ladder durable and stable to use. Great for a wide variety of tasks.

- Multi-function top with tool and bucket holders
- Wide, non-slip steps
- Spreader braces inside fiberglass rails help keep braces from getting hooked or abused in transit
- Heavy duty rubber boot shoe
- Meets or exceeds the safety standards set by ANSI and OSHA
- 300 lb work load capacity



0233426

Extension Ladders

- Non-Conductive Fiberglass Type IA 300 lb capacity, "Quick-Latch" safety on rung locks

QuickLatch® provides easier method of securing fly and base sections when extended. One-finger operation.



Steel swivel safety shoe with metal shield can be used with tread down or in spike position.



Outside slide guides secured to top of base section with four rivets per guide for maximum strength. Over extending stop on fly section.



D-shaped rungs provide greater standing area than round rungs. Fully serrated for slip-resistant surface.



Mar-resistant rail end caps on all rail ends provide rail protection for longer life and protect work surfaces from marring.



Fastenal Green Product
Environmentally preferred products (certified or non-certified).
For more information, contact gogreen@fastenal.com

Distributed Exclusively by
FASTENAL®